

# OCEAN DREAM

Costa Blanca Sur / Torrevieja (Alicante)

## URBANISATION



### **New build apartments just 300 meters from the beach.**

Ocean Dream by TM is located in the privileged area of Rocío del Mar-Punta Prima: next to the Lo Ferris Protected Natural Area, just 300 meters from Cala Piteras beach and just 5 minutes from Torrevieja. The development will have a total of 36 apartments with 2 and 3 bedrooms with 2 bathrooms and with extraordinary sea views from most of them. The common areas will be located on the roof terrace, an ideal place to enjoy the best sunrise or sunset thanks to its 360° views. What do the common areas include? Infinity pool with 3 water beds, jacuzzi and chill out area. Make Ocean Dream by TM your home, where the sea and your dreams are one.

## THE SURROUNDING AREA



### **The Beaches**

Just 300 meters from Cala Piteras beach and 700 meters from Punta Prima beach. In addition, 3 minutes by car ( $\pm 3$  km) we have Playa Flamenca.

### **Golf courses**

In the area we have several golf courses, the closest being Villamartín Golf, just 5 km away, and also Campoamor Golf and Las Colinas Golf.

### **Amenities**

Close to a wide range of services within walking distance such as restaurants, pharmacies and supermarkets. Just 5 minutes by car to shopping centres such as Zenia Boulevard and Habaneras. The development is located less than 45 minutes by car from Alicante Airport and Murcia Airport in Corvera



PLANS

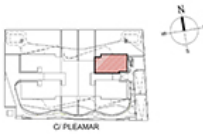

R#	SUPERFICIES UTILES / FLOOR AREA / SURFACES UTILES	TIPO TYPE	A.a
1	VES TIBULO / HALL / ENTRÉ		2,85 m <sup>2</sup>
2	PASO 1 / CORRIDOR 1 / CIRCULATION 1		3,10 m <sup>2</sup>
7	GALLERIA / GALLERY / GALLERIE		2,92 m <sup>2</sup>
8	SALÓN COMEDOR COCINA / LIVING-DINING ROOM KITCHEN / SALON-SALLE A MANGER CUISINE		29,50 m <sup>2</sup>
9	DORMITORIO 1 / BEDROOM 1 / CHAMBRE 1		12,61 m <sup>2</sup>
10	DORMITORIO 2 / BEDROOM 2 / CHAMBRE 2		9,70 m <sup>2</sup>
12	BAÑO 1 / BATHROOM 1 / SALLE DE BAINS 1		4,19 m <sup>2</sup>
13	BAÑO 2 / BATHROOM 2 / SALLE DE BAINS 2		3,68 m <sup>2</sup>
TOTAL SUP. UTILES / TOTAL FLOOR AREA / TOTAL SURFACES UTILES			68,15 m <sup>2</sup>
SUP. CONSTRUIDA INTERIOR / BUILT INTERIOR AREA / SURFACE CONSTRUITE INTERIEUR			80,11 m <sup>2</sup>
16	SUP. CONSTRUIDA PORCHE / BUILT PORCH AREA / SURFACE CONSTRUITE PORCHE		15,48 m <sup>2</sup>
TOTAL SUP. CONSTRUIDA PRIVADA / TOTAL BUILT PRIVATE AREA / TOTAL SURFACE CONSTRUITE PRIVEE			95,59 m <sup>2</sup>
SUP. TERRAZA ENLOSGADA			55,00 m <sup>2</sup>
SUP. JARDN / GARDEN AREA / SURFACE JARDN			97 m <sup>2</sup>

TIPO / TYPE A.a

NOVIEMBRE / NOVEMBER / NOVEMBRE 2022

Apartamento, 2 Dormitorios + 2 baños - Planta Baja  
Apartment, 2 Bedrooms + 2 Bathrooms - Ground Floor  
Appartement, 2 Chambres + 2 Salles de bains - Rez-de-Chaussee



Plans sujetos a posibles modificaciones por razones o exigencias de índole técnica o jurídica. Las superficies son aproximadas. Contra el amueblamiento orientado, en caso contrario, Plans subject to possible modifications for technical or legal reasons. Measurements shown are approximate. Kitchen and Living area for display purposes only, with no contract in view. Plans soumis à modifications en fonction des besoins ou exigences d'ordre technique ou juridique. Les surfaces sont approximatives. Cuisine et aménagement indicatifs, sans valeur contractuelle.

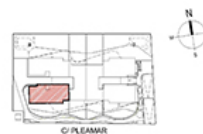

R#	SUPERFICIES UTILES / FLOOR AREA / SURFACES UTILES	TIPO TYPE	D.b
1	VES TIBULO / HALL / ENTRÉ		2,85 m <sup>2</sup>
2	PASO 1 / CORRIDOR 1 / CIRCULATION 1		4,70 m <sup>2</sup>
7	GALLERIA / GALLERY / GALLERIE		2,92 m <sup>2</sup>
8	SALÓN COMEDOR COCINA / LIVING-DINING ROOM KITCHEN / SALON-SALLE A MANGER CUISINE		29,81 m <sup>2</sup>
9	DORMITORIO 1 / BEDROOM 1 / CHAMBRE 1		14,00 m <sup>2</sup>
10	DORMITORIO 2 / BEDROOM 2 / CHAMBRE 2		9,70 m <sup>2</sup>
11	DORMITORIO 3 / BEDROOM 3 / CHAMBRE 3		9,04 m <sup>2</sup>
12	BAÑO 1 / BATHROOM 1 / SALLE DE BAINS 1		4,16 m <sup>2</sup>
13	BAÑO 2 / BATHROOM 2 / SALLE DE BAINS 2		3,50 m <sup>2</sup>
TOTAL SUP. UTILES / TOTAL FLOOR AREA / TOTAL SURFACES UTILES			80,68 m <sup>2</sup>
SUP. CONSTRUIDA INTERIOR / BUILT INTERIOR AREA / SURFACE CONSTRUITE INTERIEUR			95,52 m <sup>2</sup>
16	SUP. CONSTRUIDA PORCHE / BUILT PORCH AREA / SURFACE CONSTRUITE PORCHE		20,82 m <sup>2</sup>
TOTAL SUP. CONSTRUIDA PRIVADA / TOTAL BUILT PRIVATE AREA / TOTAL SURFACE CONSTRUITE PRIVEE			116,34 m <sup>2</sup>
SUP. TERRAZA ENLOSGADA			29,00 m <sup>2</sup>
SUP. JARDN / GARDEN AREA / SURFACE JARDN			36 m <sup>2</sup>

TIPO / TYPE D.b

NOVIEMBRE / NOVEMBER / NOVEMBRE 2022

Apartamento, 3 Dormitorios + 2 baños - Planta Baja  
Apartment, 3 Bedrooms + 2 Bathrooms - Ground Floor  
Appartement, 3 Chambres + 2 Salles de bains - Rez-de-Chaussee



Plans sujetos a posibles modificaciones por razones o exigencias de índole técnica o jurídica. Las superficies son aproximadas. Contra el amueblamiento orientado, en caso contrario, Plans subject to possible modifications for technical or legal reasons. Measurements shown are approximate. Kitchen and Living area for display purposes only, with no contract in view. Plans soumis à modifications en fonction des besoins ou exigences d'ordre technique ou juridique. Les surfaces sont approximatives. Cuisine et aménagement indicatifs, sans valeur contractuelle.

# AERIAL VIEW





# PLAN OF THE COMPLEX

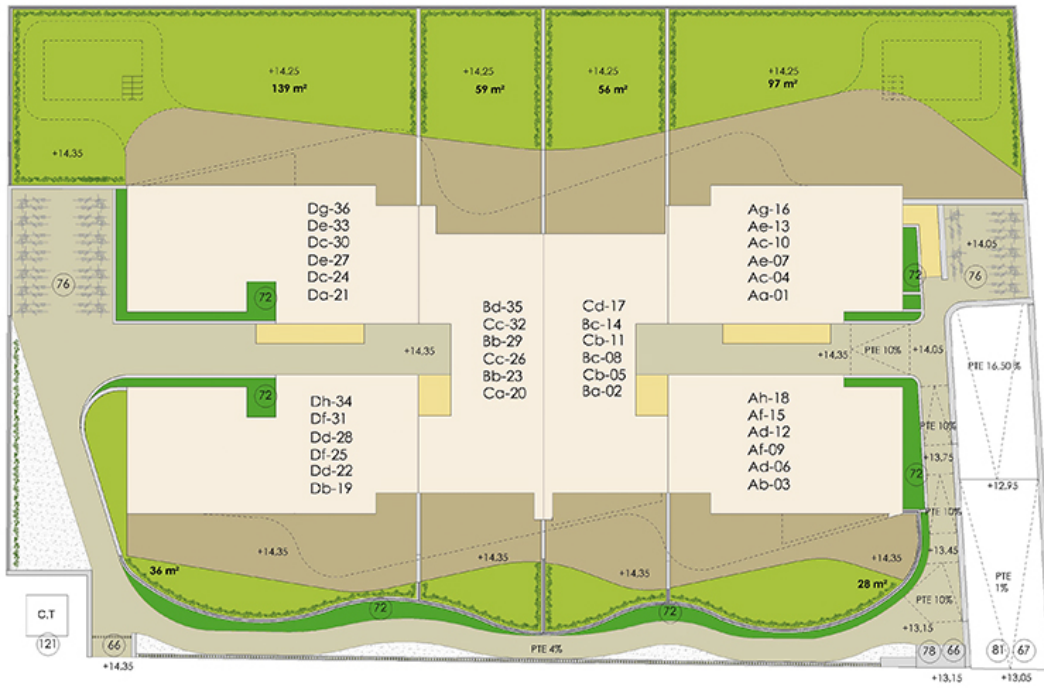

C/ PLEAMAR



## PROPERTIES AVAILABLE

Type	Bedrooms	Bathrooms	Price range	m2
Apartment	2	2	287.000€ - 336.000€	91 - 120
Apartment	3	2	319.000€ - 423.000€	115 - 145



Solicita información en la oficina de venta TM más cercana a tu domicilio o ponte en contacto con nosotros en el teléfono **902 15 15 12** o en la dirección de email **[comercial@tmgrupoinmobiliario.com](mailto:comercial@tmgrupoinmobiliario.com)**

**TM GRUPO INMOBILIARIO**